



**Working Together  
for You.**

### Robert Pettit

**Direct** (225) 769-0405

**Email** Robert@waterspettit.com

### Geordy Waters CCIM

**Direct** (225) 769-0405

**Email** Geordy@waterspettit.com

### Waters & Pettit Commercial Real Estate

8054 Summa Avenue, Suite E  
Baton Rouge, LA 70809

## Retail/Restaurant/Office Space For Lease

1509 GOVERNMENT STREET, BATON ROUGE, LA

OVERVIEW

ELECTRIC DEPOT



Phase I of the revitalization of the old Entergy power plant on Government Street in Baton Rouge's Mid-City has been completed. Over 30,000 square feet of retail, restaurant and entertainment space has been leased. Come be a part of this unique "social space" known as ELECTRIC DEPOT - the premier redevelopment project in the Capital Region.

In addition to a vibrant tenant mix, Electric Depot has a central green lawn for guests to gather, relax and enjoy periodic outdoor concert events.

Phase I to include approximately 250 onsite parking spaces.

#### Red Stick Social:

A multi-level 25,000 square foot entertainment venue with bowling alleys, live music, private party spaces, restaurant & bar, recently opened for business in April. Other tenants scheduled to be opening soon include:

#### City Roots:

A new coffee concept by Matt Saurage of Community Coffee - on site coffee bean roasting, handcrafted coffees, nitro-coffees, draft lattes, teas and weekly coffee tastings.

#### BÖRU:

An exciting new Japanese ramen and poke eatery operated by the owners of Ichiban Japanese Grill & Sushi Bar.

#### Achroma:

A photography studio and art gallery.

#### Blue Corn Tequila & Tacos:

2nd location for this popular traditional Mexican restaurant (opening in summer of 2020)

### PHASE I -

Building A:	25,000-SF (LEASED)
Building B:	*4,570 SF
Building C:	3,908 SF + Patio
Building D:	3,366-SF (LEASED)
Lease Rate:	SEE AGENT

*\*Minimum leaseable area is 700+/- Sq ft*



Ph (225) 769-0405

waterspettit.com

facebook.com/WatersPettit

*Even though obtained from sources deemed reliable, no warranty or representation, expressed or implied is made as to the accuracy of the information herein, and it is subject to errors, omissions, change of price, rental or other conditions, withdrawal without notice, and to any special listing conditions imposed by our principals.*





**Working Together  
for You.**

### Robert Pettit

**Direct** (225) 769-0405

**Email** Robert@waterspettit.com

### Geordy Waters CCIM

**Direct** (225) 769-0405

**Email** Geordy@waterspettit.com

### Waters & Pettit Commercial Real Estate

8054 Summa Avenue, Suite E  
Baton Rouge, LA 70809

## Retail/Restaurant/Office Space For Lease

1509 GOVERNMENT STREET, BATON ROUGE, LA

PHOTOS

ELECTRIC DEPOT

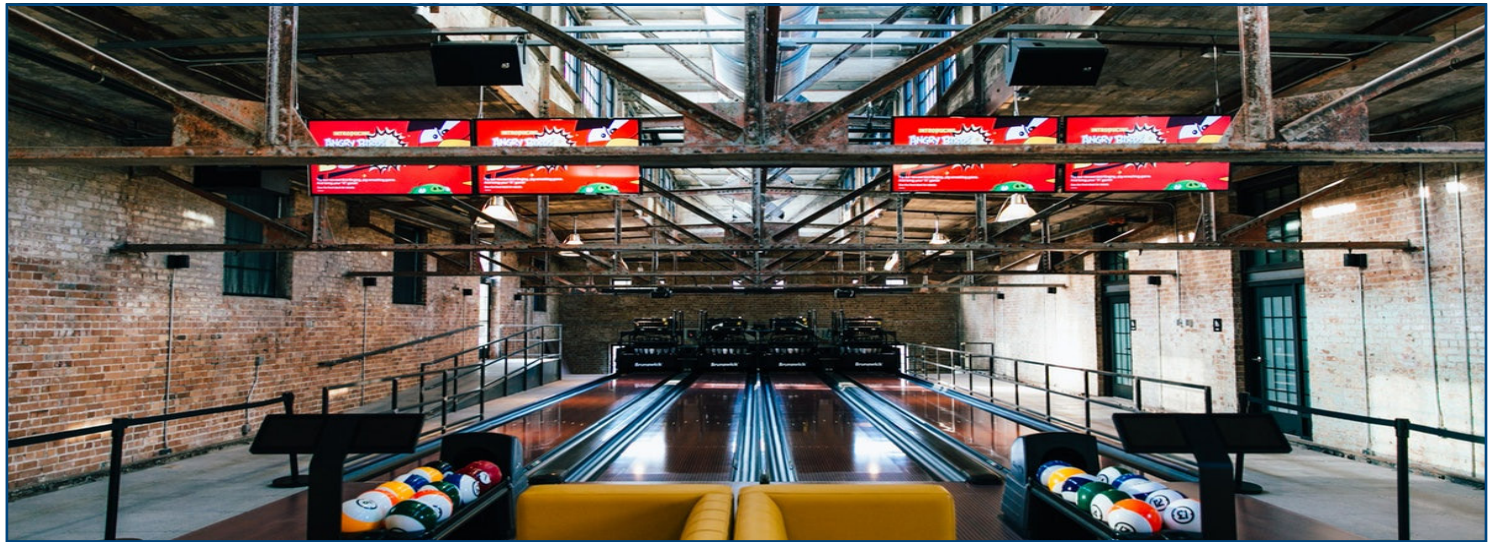

Ph (225) 769-0405

[waterspettit.com](http://waterspettit.com)



[facebook.com/WatersPettit](https://facebook.com/WatersPettit)

*Even though obtained from sources deemed reliable, no warranty or representation, expressed or implied is made as to the accuracy of the information herein, and it is subject to errors, omissions, change of price, rental or other conditions, withdrawal without notice, and to any special listing conditions imposed by our principals.*





**Working Together  
for You.**

### Robert Pettit

**Direct** (225) 769-0405

**Email** Robert@waterspettit.com

### Geordy Waters CCIM

**Direct** (225) 769-0405

**Email** Geordy@waterspettit.com

### Waters & Pettit Commercial Real Estate

8054 Summa Avenue, Suite E  
Baton Rouge, LA 70809

## Retail/Restaurant/Office Space For Lease

1509 GOVERNMENT STREET, BATON ROUGE, LA

**BUILDING B**

**ELECTRIC DEPOT**



Retail or Office

Only 4,570 SF remains!

Demising walls not in place.  
Suite sizes and layout can be  
modified to suit needs.

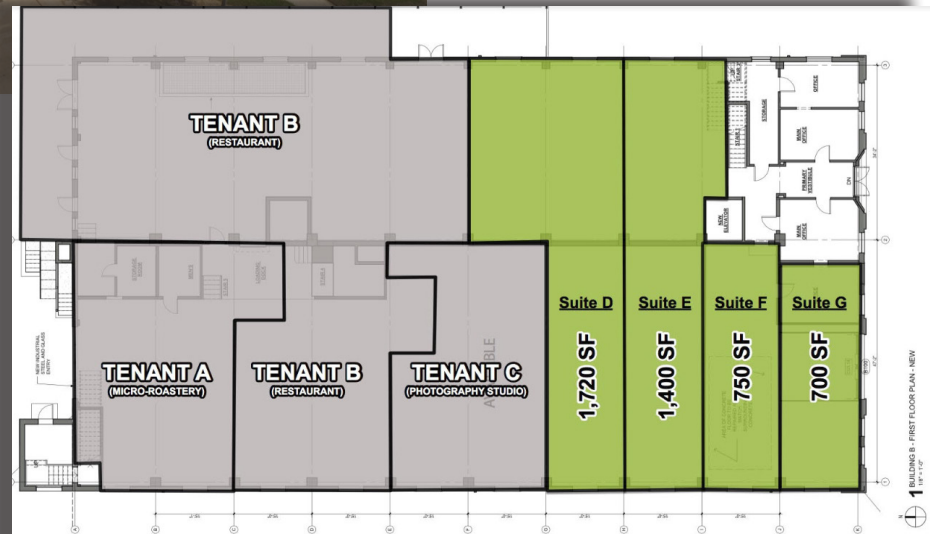

**Ph** (225) 769-0405

**waterspettit.com**



**facebook.com/WatersPettit**

*Even though obtained from sources deemed reliable, no warranty or representation, expressed or implied is made as to the accuracy of the information herein, and it is subject to errors, omissions, change of price, rental or other conditions, withdrawal without notice, and to any special listing conditions imposed by our principals.*



**Working Together  
for You.**

### Robert Pettit

**Direct** (225) 769-0405

**Email** Robert@waterspettit.com

### Geordy Waters CCIM

**Direct** (225) 769-0405

**Email** Geordy@waterspettit.com

### Waters & Pettit Commercial Real Estate

8054 Summa Avenue, Suite E  
Baton Rouge, LA 70809

## Retail/Restaurant/Office Space For Lease

1509 GOVERNMENT STREET, BATON ROUGE, LA

**BUILDING C**

**ELECTRIC DEPOT**



Office or Retail

Interior (Climate Controlled): 3,908 SF

Patio/Deck: 540 SF

Total: 4,448 SF

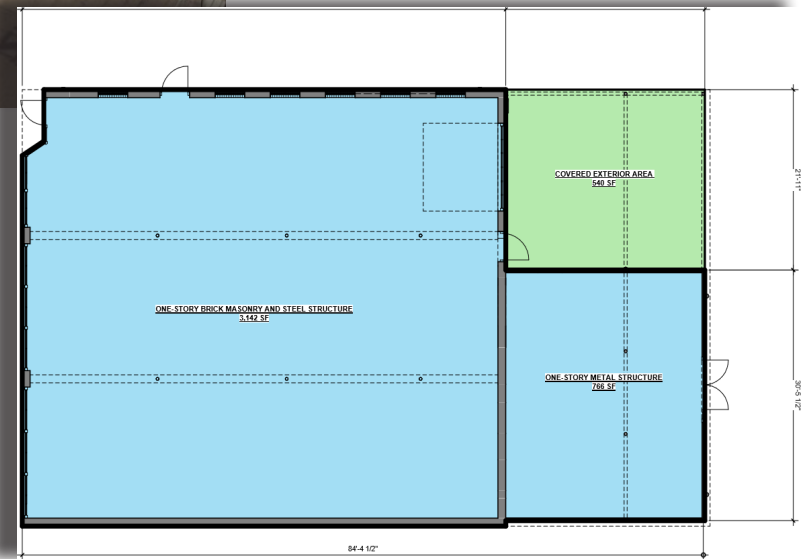

**Ph** (225) 769-0405

**waterspettit.com**



**facebook.com/WatersPettit**

*Even though obtained from sources deemed reliable, no warranty or representation, expressed or implied is made as to the accuracy of the information herein, and it is subject to errors, omissions, change of price, rental or other conditions, withdrawal without notice, and to any special listing conditions imposed by our principals.*



**Email** Robert@waterspettit.com

**Email** [Geordy@waterspettit.com](mailto:Geordy@waterspettit.com)

8054 Summa Avenue, Suite E  
Baton Rouge, LA 70809

**1509 GOVERNMENT STREET, BATON ROUGE, LA**

**ELECTRIC DEPOT**



Interior (Climate Controlled)	1,93 SF
Patio/Deck:	1,93 SF
Total:	4,559 SF



**waterspettit.com**



*Even though obtained from sources deemed reliable, no warranty or representation, expressed or implied is made as to the accuracy of the information herein, and it is subject to errors, omissions, change of price, rental or other conditions, withdrawal without notice, and to any special listing conditions imposed by our principals.*





**Working Together  
for You.**

### Robert Pettit

**Direct** (225) 769-0405

**Email** Robert@waterspettit.com

### Geordy Waters CCIM

**Direct** (225) 769-0405

**Email** Geordy@waterspettit.com

### Waters & Pettit Commercial Real Estate

8054 Summa Avenue, Suite E  
Baton Rouge, LA 70809

## Retail/Restaurant/Office Space For Lease

1509 GOVERNMENT STREET, BATON ROUGE, LA

SITE PLAN

ELECTRIC DEPOT



Ph (225) 769-0405

[waterspettit.com](http://waterspettit.com)



[facebook.com/WatersPettit](https://facebook.com/WatersPettit)

*Even though obtained from sources deemed reliable, no warranty or representation, expressed or implied is made as to the accuracy of the information herein, and it is subject to errors, omissions, change of price, rental or other conditions, withdrawal without notice, and to any special listing conditions imposed by our principals.*





**Working Together  
for You.**

### Robert Pettit

**Direct** (225) 769-0405

**Email** Robert@waterspettit.com

### Geordy Waters CCIM

**Direct** (225) 769-0405

**Email** Geordy@waterspettit.com

### Waters & Pettit Commercial Real Estate

8054 Summa Avenue, Suite E  
Baton Rouge, LA 70809

## Retail/Restaurant/Office Space For Lease

1509 GOVERNMENT STREET, BATON ROUGE, LA

LOCATION

ELECTRIC DEPOT



Ph (225) 769-0405

[waterspettit.com](http://waterspettit.com)



[facebook.com/WatersPettit](https://facebook.com/WatersPettit)

*Even though obtained from sources deemed reliable, no warranty or representation, expressed or implied is made as to the accuracy of the information herein, and it is subject to errors, omissions, change of price, rental or other conditions, withdrawal without notice, and to any special listing conditions imposed by our principals.*